



Principal Particulars

Length overall	32.9	metres
Length waterline	32.4	metres
Moulded beam	10.6	metres
Design draught	1.7	metres

Deadweight

Technicians	28	
Crew	3-6	
Cargo	30	tonnes
Fuel	50,000	litres
Fresh water	4,000	litres
Black water	4,000	litres
Maximum deadweight	60	tonnes



Performance & Range

Speed	26.0	knots
Service speed	24.0	knots

Machinery

Power	2648 kW
Propulsors	Quad CPP
Bow thruster	Twin (one per hull)
Generators	2* 30 kW



Construction

Hull	Aluminium
Superstructure	Aluminium

Design Standard

Class	ASB
Flag	USCG

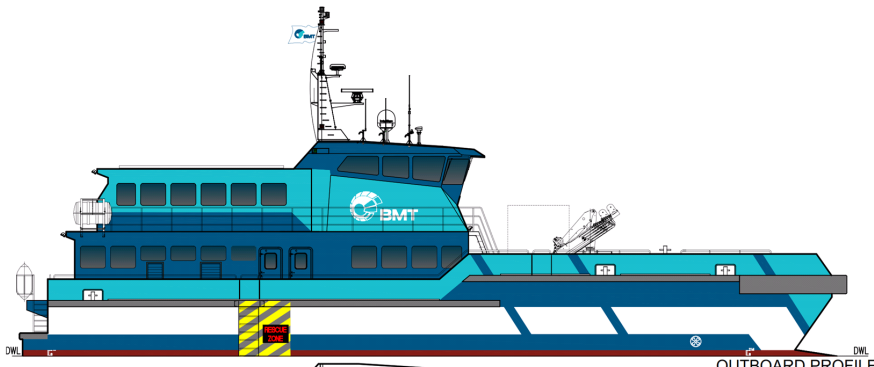

OUTBOARD PROFILE

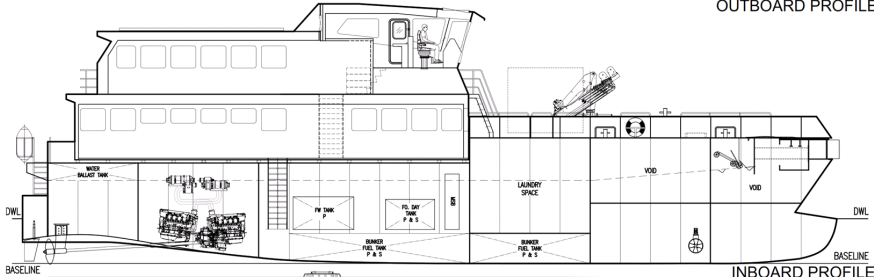
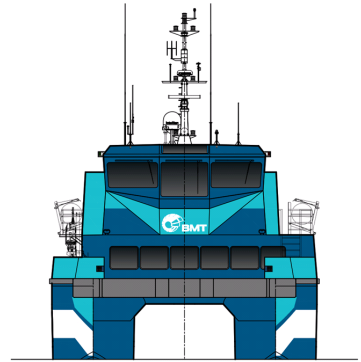

INBOARD PROFILE

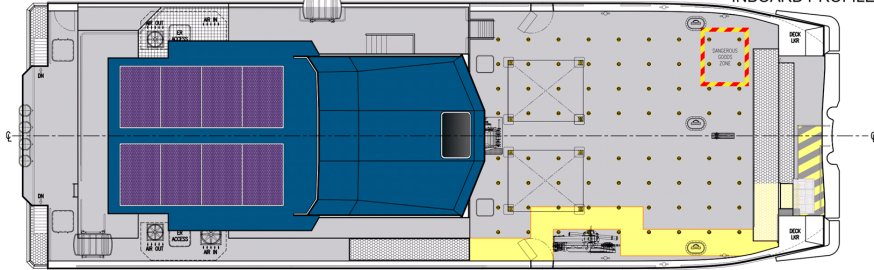

PLAN VIEW WHEELHOUSE

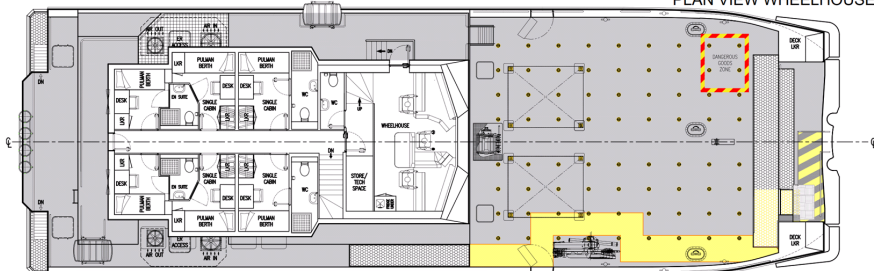

PLAN VIEW ON UPPER DECK

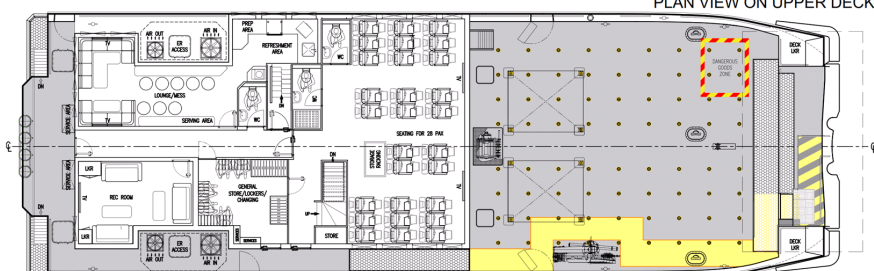

PLAN VIEW ON MAIN DECK

BMT ACTIVE FENDER SYSTEM
 PROTECTED BY PATENT:
 No.08/498252,
 No.082001923.8,
 No.082001920.4

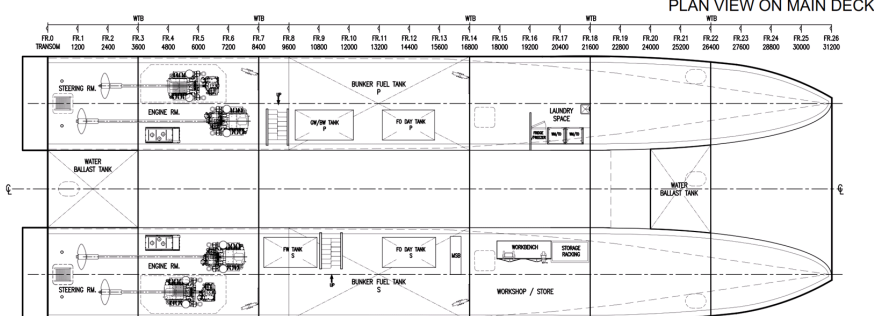

PLAN VIEW ON HULL